

TAB TENSION ADJUSTABLE BACK

A step up from standard sling-back backrests, the PC Tab Tension Adjustable Back offers tool-free configuration to provide secure and customised back support. Designed without a hardshell, it ensures excellent breathability, promoting skin comfort and temperature regulation during hot days.

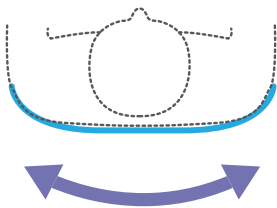

Key features / Clinical justification



Provides adjustable support
for maximum comfort

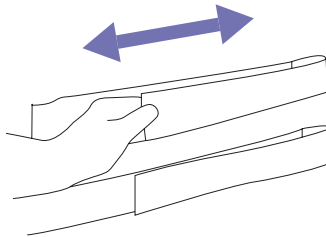

Adjustable straps ensure
stable and customised
support

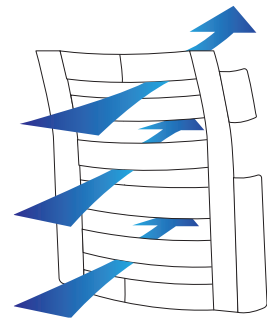

Breathable fabric
construction enhances
micro-climate regulation,
improving seating
tolerance

HPCPS E2611, E2612

Specification

- 1" High Density High Resiliency Foam Pad
- Height 18"
- Width Options 16"-24"